

EVERHARD SPEC PACK



A family
owned
Australian
business

ESTABLISHED
1926

PRODUCT INFO | IMAGES | DRAWINGS

PRODUCT

Nugleam All In One 1TH RH Laundry Unit

EI CODE

77060

BRAND

Nugleam



SPEC PACK LAUNDRY COLLECTION

SPEC SHEET



NUGLEAM ALL IN ONE 1TH RH LAUNDRY UNIT

PRODUCT CODE:

77060

FEATURES:

- / 45L bowl moulded into the bench with intergrated overflow
- / Gloss white 50mm thick polymarble bench
- / 90mm basket waste
- / Accomodates all standard sized front loader washing machines
- / Available in left hand or right hand configurations or without taphole
- / Two spacious soft close drawers on heavy duty runners

OVERALL DIMENSIONS:

1200 W x 940 H x 610mm D

PRODUCT VARIATIONS:

77061 | Nugleam All In One 1TH LH Laundry Unit

77062 | Nugleam All In One NTH Laundry Unit

WARRANTY:

5 years

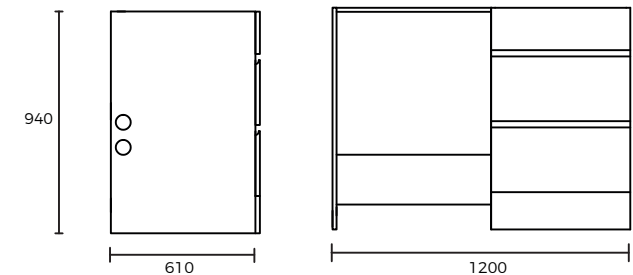

Disclaimer: All measurement are in millimetres and are solely for reference purposes. Colours have been reproduced with as much accuracy as possible. Any changes resulting from technical advance of design or colour may be made without prior notice. Tapware, accessories and appliances are for illustration purposes only. Further information on warranties is available at www.everhard.com.au

SPEC PACK LAUNDRY COLLECTION

PRODUCT DRAWING

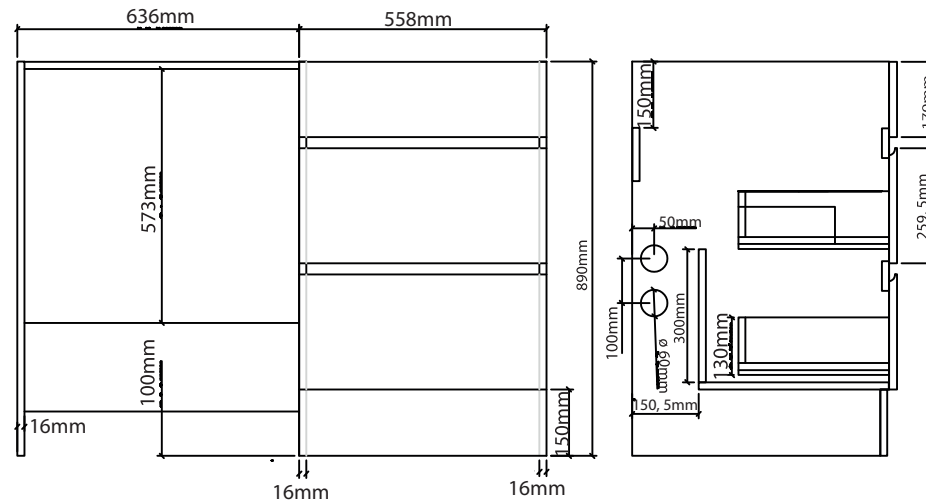

Cabinet Only

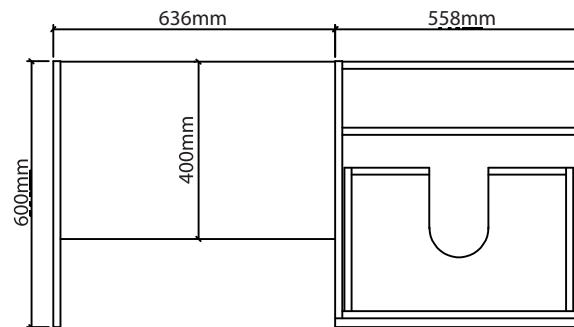

Cabinet Size: 1194 x 600 x 890mm H
Benchtop: 1200 x 610 x 50mm H